



INSTRUCTION BULLETIN

No. 340807
Machine: M20
Published: 02-2007
Rev. 02

NOTE: DO NOT DISCARD the Parts List from the Instruction Bulletin. Place the Parts List in the appropriate place in the machine manual for future reference. Retaining the Parts List will make it easier to reorder individual parts and will save the cost of ordering an entire kit.

NOTE: Numbers in parenthesis () are reference numbers for parts listed in Bill of Materials.

Installation instructions for **kit number 9002434**

SYNOPSIS:

This kit contains the parts needed to replace the control panel assembly on M20 machines. Please follow step-by-step instructions.

SPECIAL TOOLS / CONSIDERATIONS: NONE

(Estimated time to complete: 1 hour)

*NOTE: Record hours from the hour meter before removing the old control panel from the machine. The new control panel (1) is set to zero hours. Tennant Service Representatives please call Business Administrative Associate (**NOT** Warranty).*

NOTE: If custom settings are used (ask operator/customer), record settings before removing the control board from the machine. Machine defaults back to factory settings after circuit board is replaced. Down pressure, solution delivery, and detergent delivery settings must be changed back to custom settings if custom settings are used. Consult the Tennant Technical Support Group for instructions how to access, read, and reset custom settings.

PREPARATION:

1. Park machine on a clean level surface, turn off machine, remove key, and set parking brake.

FOR SAFETY: Before leaving or servicing machine, stop on level surface, set parking brake, turn off machine, and remove key.

2. First disconnect the negative terminal and then the positive terminal from the battery. Remove the battery from the machine.



WARNING: Always disconnect battery cables from machine before working on electrical components.

3. Disconnect the two main wire harness connectors from the circuit board.
4. Remove the two hex nuts holding the battery flap and retaining bar to the back of the dash panel. Set the battery flap and retaining bar aside. Mounting hardware has changed, discard existing hex nuts. Refer to Fig. 2.

5. Remove the two hex nuts holding the bottom of the control panel to the back of the dash panel. Mounting hardware has changed, discard existing hex nuts. Refer to Fig. 2.

6. Remove the control panel from the dash panel. Send the control panel back to Tennant Warranty Department. Refer to Fig. 2.

INSTALLATION:

1. Use four hex nuts (2) and four nylon bushings (3) to install the new control panel (1), battery cover, and retaining bar onto the dash panel. Refer to Fig. 2.

*NOTE: The nylon bushings (3) **must be installed** as shown in Fig. 2 to prevent static electricity from damaging the control panel (1).*

2. Reconnect the main wire harness to the control panel (1).
3. Set the battery into the battery compartment. Reconnect the positive terminal first and then the negative terminal.

NOTE: Refer to Steps 4 through 6 to reconfigure the control panel (1) so it matches the machine.

- To enter configuration mode: Simultaneously press and hold the 4/5 button (A) and Side Brush button (B) and turn the ignition switch to the on position (without starting machine). Refer to Fig. 1.

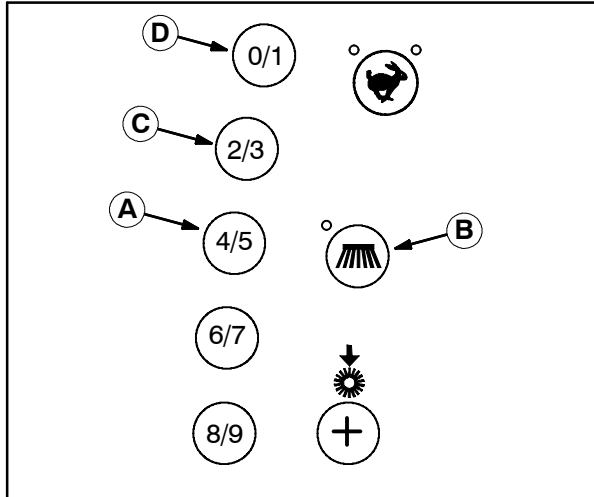

FIG. 1

- To select configuration: Use the 2/3 button (C) to scroll to the proper mode (**ES**, **FaST**, or **No ES**, **No FaST** option from the menu) and use the 0/1 (D) button to select the applicable mode. Refer to Fig. 1.
- If machine is equipped with the **Side Brush Sweep Only** option reenter the configuration mode and select **Side Brush Sweep Only** from the configuration menu. Refer to Fig. 1.

NOTE: If custom settings are used (ask operator/customer), record settings before removing the control board from the machine. Machine defaults back to factory settings after circuit board is replaced. Down pressure, solution delivery, and detergent delivery settings must be changed back to custom settings if custom settings are used. Consult the Tennant Technical Support Group for instructions how to read and reset custom settings.

- Start and test the machine. Verify the machine operates properly.

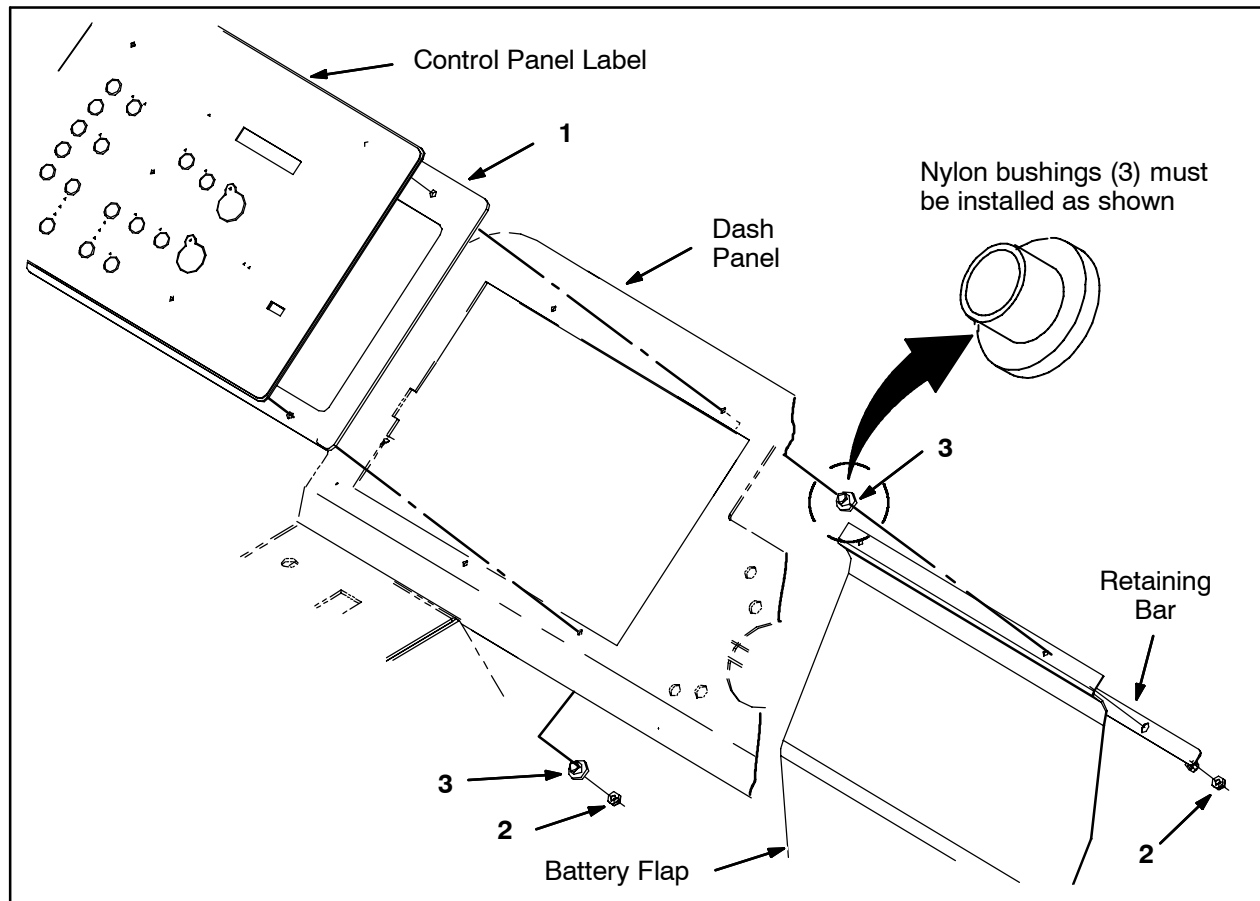

FIG. 2

Bill of Materials for Panel Kit, Instmt, Repair [M20]-9002434

	Ref.	Tennant Part No.	Description	Qty.
▽		9002434	Panel Kit, Instmt, Repair [M20]	1
▲	1	1018410	Circuitboard Assy [M20/T20]	1
▲	2	1018410	Nut, Hex, Lock, M4 X 0.70, NL, SS	4
▲	3	1029362	Washer, Shld, Nyl [8-32]	4

TENNANT COMPANY
P. O. Box 1452
Minneapolis, MN 55440-1452